

---

## **SAMUEL BRIGHOUSE ELEMENTARY SCHOOL SIX PREFABRICATED CLASSROOMS**

---

<b>CONSTRUCTION START:</b>	February 2024
<b>COMPLETION:</b>	September 2024
<b>PROJECT BUDGET:</b>	\$6 Million
<b>FUNDING SOURCES:</b>	Ministry of Education and Child Care Capital Plan - \$9 Million (maximum)
<b>CONSULTANT:</b>	F.J. Geyer Consulting
<b>CONSTRUCTION MANAGER:</b>	Unitech Construction Management Ltd.
<b>DESIGN/BUILDER:</b>	Fort Modular Inc.
<b>PROJECT MANAGER:</b>	Richmond Project Team Enquiries: Frank Geyer, 604-616-8565

### **BACKGROUND**

The 2023/2024 Richmond Board of Education Capital Plan included a six-classroom addition for R.C. Brighthouse Elementary in order to partially address the population and enrolment growth in the City Centre and West Cambie planning areas.

The Ministry of Education and Child Care (MECC), at its Capital Working Session with executives from high growth school districts in the Lower Mainland/Interior/Vancouver Island 28 June 2023, emphasized the need to investigate opportunities for prefabricated construction and repeatable floor plans as a means for expediting much needed classroom space in a faster, more cost-effective manner than conventional construction.

In response to MECC's mandate, on 30 August 2023 the Richmond School District designed and submitted an unsolicited proposal to install fully self-contained, prefabricated (modular) classroom annexes at two City Centre area elementary schools (Brighthouse, Cook) and two West Cambie area elementary schools (Talmey and Tomsett). Samuel Brighthouse Elementary is the first prefabricated classrooms project approved by MECC for School District No. 38 (Richmond).

### **PROJECT SCOPE**

- Design and factory prefabrication of individual energy efficient, low-carbon classroom and specialty (washroom, learning assistance) units, with exteriors to match cladding style and colours of the school.
- Site preparation for the six-classroom annex, including school garden relocation, excavation, backfill, retaining wall, underground utilities and parking lot expansion..
- Delivery and installation of the prefabricated six-classroom annex, including aircraft-grade aluminum ramps and stairs.
- Playground and basketball courts addition, landscaping and move-in.

**PROJECT STATUS**

- Project approval and funding agreement received from the Ministry of Education and Child Care 25 October 2023.
- Site preparation and building fabrication started in February 2024.
- Project completed on time and within budget.



Artist's Renderings - Samuel Brighthouse Elementary Annex

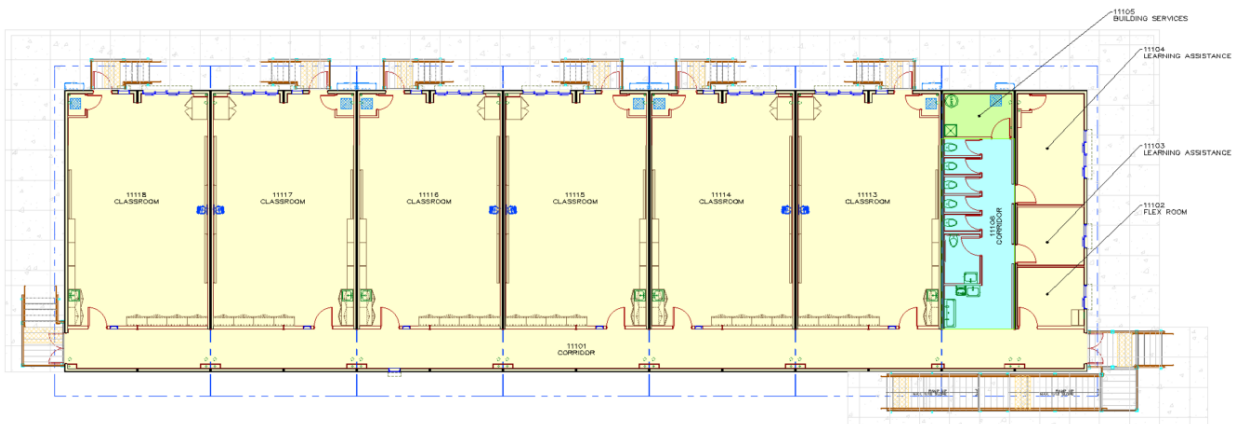

Floor Plan - Samuel Brighthouse Elementary Annex

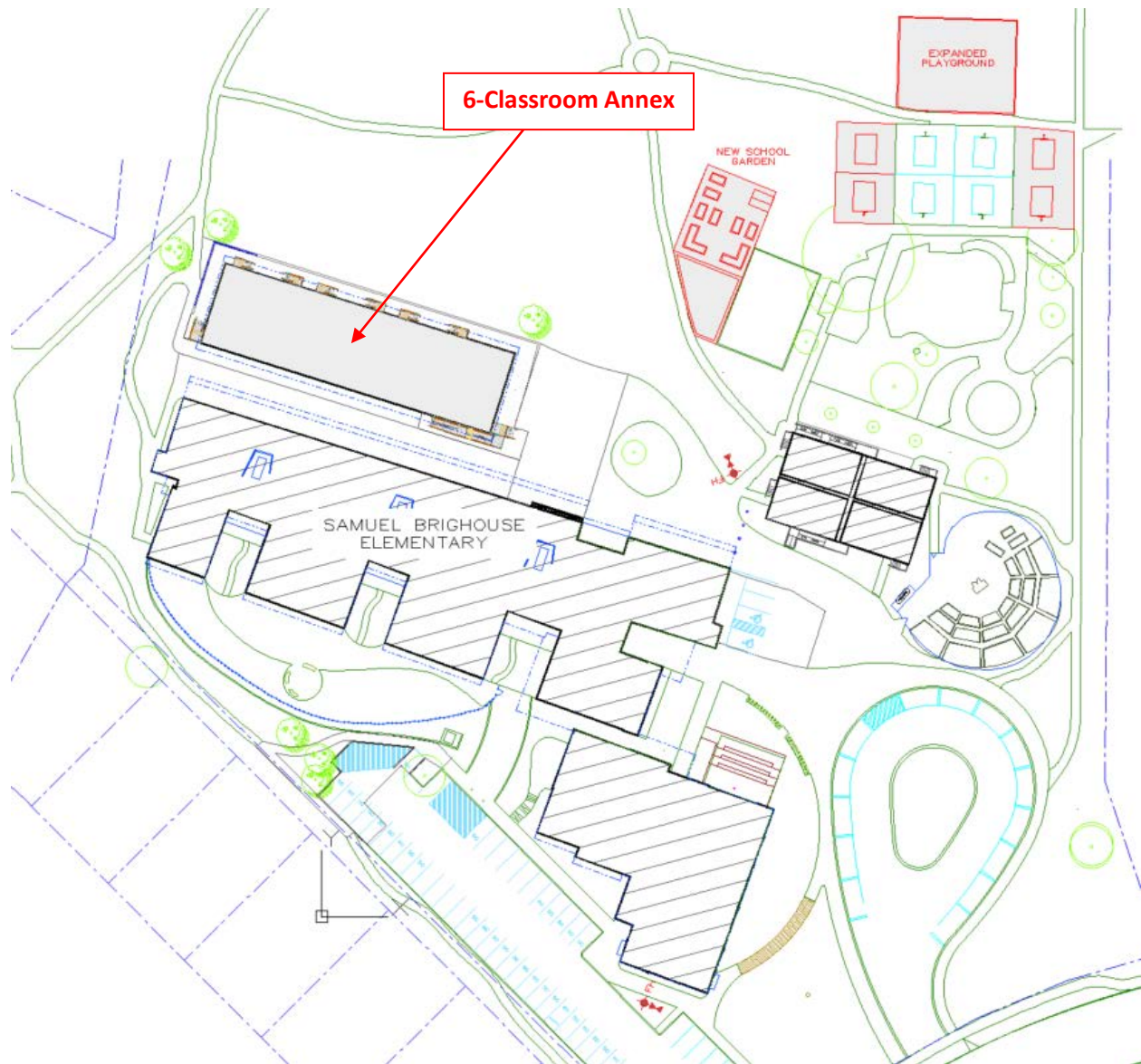

Project Site Plan - Samuel Brighthouse Elementary Annex